

# GF Tech-Tips

Date Issued: 10/24/2023

## Transitioning from PPro Seal to PROGEF

The PPro-Seal PP piping system has been retired. For repairs or expansions to existing PPro-Seal piping systems, use the PPro-Seal x PROGEF PP Natural transition couplings. These Natural PP transition couplings are designed with a PPro-Seal electrofusion side, complete with coil, and a metric socket side. Making the transition from the standard inch size PPro-Seal to a metric PROGEF piping system simple.

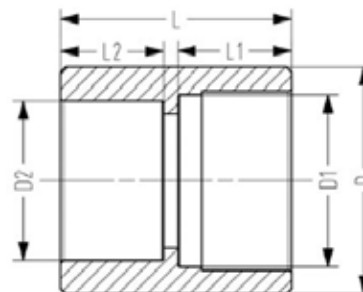

Size (inch D2 x mm D1)	Code	D (mm)	D1 (mm)	D2 (mm)	L (mm)	L1 (mm)	L2 (mm)
1/2" x 20mm	150 900 224	31	20.0	0.5	35.0	18.25	16
3/4" x 25mm	150 900 212	36	25.0	0.75	41.0	20.00	18
1" x 32mm	150 900 214	44	32.0	1.0	45.0	22.20	20
1 1/2" x 50mm	150 900 937	62	50.0	1.5	57.2	26.00	25
2" x 63mm	150 900 586	82	63.0	2.0	62.0	26.90	29



### Fusion Equipment

- 150.000.001 Electro Plus®
- 790.105.097 MSE 63 hand held socket fusion tool
- 799.300.156 20mm Type B Heating spigot and bush, PTFE coated
- 799.300.157 25mm Type B Heating spigot and bush, PTFE coated
- 799.300.158 32mm Type B Heating spigot and bush, PTFE coated
- 799.300.159 40mm Type B Heating spigot and bush, PTFE coated
- 799.300.160 50mm Type B Heating spigot and bush, PTFE coated
- 799.300.161 63mm Type B Heating spigot and bush, PTFE coated

Subscribe to our

**YouTube Channel**

If you have any questions or need further information on other GF products, please contact your local Georg Fischer Sales Office or visit us on the web at [www.gfps.com](http://www.gfps.com)