



Absperklappe Typ 565 Handgetriebe

Ausführung:

- Installationslänge: EN558 row 20, ISO 5752 row 20, API 609 table 2
- Anschlussmasse: ISO 7005 PN10/16, EN 1092 PN10/16, DIN 2501 PN10/16, ANSI/ASME B 16.5 Class 150, BS 1560: 1989 Class 125/150; BS 4504 PN10/16, JIS B 2220 10K, JIS B 2239 10K
- Radial ein- und ausbaubar

Option:

- Armatur individuell konfigurierbar
- Handhebel sowie pneumatische und elektrische Antriebe verfügbar
- Doppelsensor zur elektrischen Positionsrückmeldung inkl. LED Anzeige

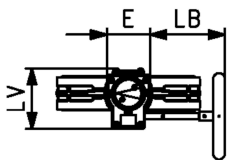
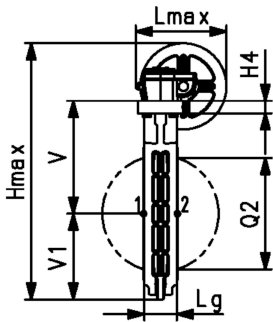
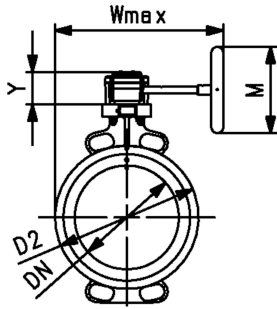

Do2 (mm)	Zoll (inch)	DN (mm)	PN (bar)	EPDM Code	SP	Gewicht (kg)	FKM Code	SP	Gewicht (kg)
63	2	50	16	199 565 200	1	3,0	199 565 220	1	3,1
75	2 ½	65	16	199 565 201	1	3,2	199 565 221	1	3,3
90	3	80	16	199 565 202	1	3,4	199 565 222	1	3,5
110	4	100	16	199 565 203	1	4,2	199 565 223	1	4,3
140	5	125	16	199 565 204	1	4,7	199 565 224	1	5,0
160	6	150	16	199 565 205	1	5,5	199 565 225	1	5,8
225	8	200	10	199 565 206	1	6,7	199 565 226	1	7,2
280	10	250	10	199 565 207	1	12,7	199 565 227	1	13,4
315	12	300	10	199 565 208	1	16,5	199 565 228	1	17,6

Do2 (mm)	Zoll (inch)	DN (mm)	D2 (mm)	Wmax (mm)	Hmax (mm)	Lmax (mm)	H4 (mm)	D1 (mm)	V1 (mm)	Lg (mm)	E (mm)	LB (mm)	LV (mm)
63	2	50	100,0	238,5	303,0	169,0	23,0	133,5	63,0	43,0	80,0	128,0	112,5
75	2 ½	65	121,0	246,0	329,0	169,0	23,0	140,0	82,0	46,0	80,0	128,0	112,5
90	3	80	138,0	248,5	341,5	169,0	23,0	146,0	89,0	46,0	80,0	128,0	112,5
110	4	100	158,5	258,5	377,5	169,0	23,0	166,5	104,0	52,0	80,0	128,0	112,5
140	5	125	187,0	272,0	405,0	169,0	23,0	180,0	118,0	56,0	80,0	128,0	112,5
160	6	150	213,0	285,5	426,5	169,0	23,0	189,0	130,5	56,0	80,0	128,0	112,5
225	8	200	267,0	312,5	475,5	169,0	23,0	209,5	195,0	60,0	80,0	128,0	112,5
280	10	250	325,5	360,5	603,0	212,5	23,0	262,5	195,5	68,0	100,0	135,5	130,0
315	12	300	380,0	387,5	659,5	212,5	23,0	284,5	230,5	78,0	100,0	135,5	130,0

Do2 (mm)	Zoll (inch)	DN (mm)	M (mm)	Y (mm)	Q2 (mm)
63	2	50	160,0	61,5	28,5
75	2 ½	65	160,0	61,5	44,0
90	3	80	160,0	61,5	63,5
110	4	100	160,0	61,5	84,0
140	5	125	160,0	61,5	110,5
160	6	150	160,0	61,5	137,5
225	8	200	160,0	61,5	191,5
280	10	250	200,0	68,5	239,0
315	12	300	200,0	68,5	285,5