



Absperklappe Typ 565 Freies Wellenende

Ausführung:

- Installationslänge: EN558 row 20, ISO 5752 row 20, API 609 table 2
- Anschlussmasse: ISO 7005 PN10/16, EN 1092 PN10/16, DIN 2501 PN10/16, ANSI/ASME B 16.5 Class 150, BS 1560: 1989 Class 125/150; BS 4504 PN10/16, JIS B 2220 10K, JIS B 2239 10K
- Radial ein- und ausbaubar

Option:

- Armatur individuell konfigurierbar
- Handhebel, Handgetriebe sowie pneumatische und elektrische Antriebe verfügbar
- Doppelsensor zur elektrischen Positionsrückmeldung inkl. LED Anzeige

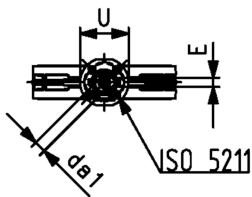
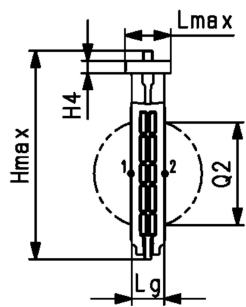
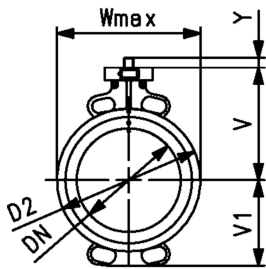

Do2 (mm)	Zoll (inch)	DN (mm)	PN (bar)	Acc.to ISO 5211	EPDM Code	SP	Gewicht (kg)
63	2	50	16	F07	199 565 100	1	0,9
75	2 ½	65	16	F07	199 565 101	1	1,1
90	3	80	16	F07	199 565 102	1	1,3
110	4	100	16	F07	199 565 103	1	2,0
140	5	125	16	F07	199 565 104	1	2,6
160	6	150	16	F07	199 565 105	1	3,7
225	8	200	10	F07	199 565 106	1	4,7
280	10	250	10	F10	199 565 107	1	8,8
315	12	300	10	F10	199 565 108	1	12,6

Do2 (mm)	Zoll (inch)	DN (mm)	FKM Code	SP	Gewicht (kg)
63	2	50	199 565 120	1	1,0
75	2 ½	65	199 565 121	1	1,2
90	3	80	199 565 122	1	1,4
110	4	100	199 565 123	1	2,2
140	5	125	199 565 124	1	2,9
160	6	150	199 565 125	1	3,8
225	8	200	199 565 126	1	5,2
280	10	250	199 565 127	1	9,5
315	12	300	199 565 128	1	13,7

Do2 (mm)	Zoll (inch)	DN (mm)	D2 (mm)	Wmax (mm)	Lmax (mm)	Hmax (mm)	H4 (mm)	D1 (mm)	V1 (mm)	Lg (mm)	da1 (mm)	E (mm)	U (mm)	Y (mm)
63	2	50	100,0	118,5	85,5	222,5	23,0	133,5	63,0	43,0	14,1	11,0	90,0	27,0
75	2 ½	65	121,0	132,5	85,5	248,5	23,0	140,0	82,0	46,0	14,1	11,0	90,0	27,0
90	3	80	138,0	138,0	85,5	261,0	23,0	146,0	89,0	46,0	14,1	11,0	90,0	27,0
110	4	100	158,5	158,5	85,5	286,0	23,0	166,5	104,0	52,0	18,1	14,0	90,0	16,0
140	5	125	187,0	187,0	85,5	313,5	23,0	180,0	118,0	56,0	18,1	14,0	90,0	16,0
160	6	150	213,0	213,0	85,5	337,5	23,0	189,0	130,5	56,0	22,2	17,0	90,0	19,0
225	8	200	267,0	267,0	85,5	387,0	23,0	209,5	195,0	60,0	22,2	17,0	90,0	19,0
280	10	250	325,5	325,5	125,5	499,0	23,0	262,5	195,5	68,0	28,2	22,0	125,0	41,0
315	12	300	380,0	380,0	125,5	555,0	23,0	284,5	230,5	78,0	28,2	22,0	125,0	41,0

Do2 (mm)	Zoll (inch)	DN (mm)	Q2 (mm)
63	2	50	28,5
75	2 ½	65	44,0
90	3	80	63,5
110	4	100	84,0
140	5	125	110,5
160	6	150	137,5
225	8	200	191,5
280	10	250	239,0
315	12	300	285,5